



Drinking water cooler / Trinkwasserkühler
DWCB25AB / DWCB50AB

Drinking water cooler DWCB25AB

Total capacity.....0,2 KW
=====

Marine Execution

Outside lining : Stainless steel
Capacity : 25 Liters/h
Freon : R134a

- Free standing for mounting on deck.
- Top of stainless steel with bubbler and glassfiller.
- Stainless steel outside housing.
- Motor protection and temperature control are factory mounted.
- Constructed for use under tropical conditions.
- With marine feet made of stainless steel and adjustable in high.
- Complete and ready for installation.

Please keep a distance of 5–10 cm to the

Please keep a distance of 5-10 cm to the back wall !!!

Bottom view

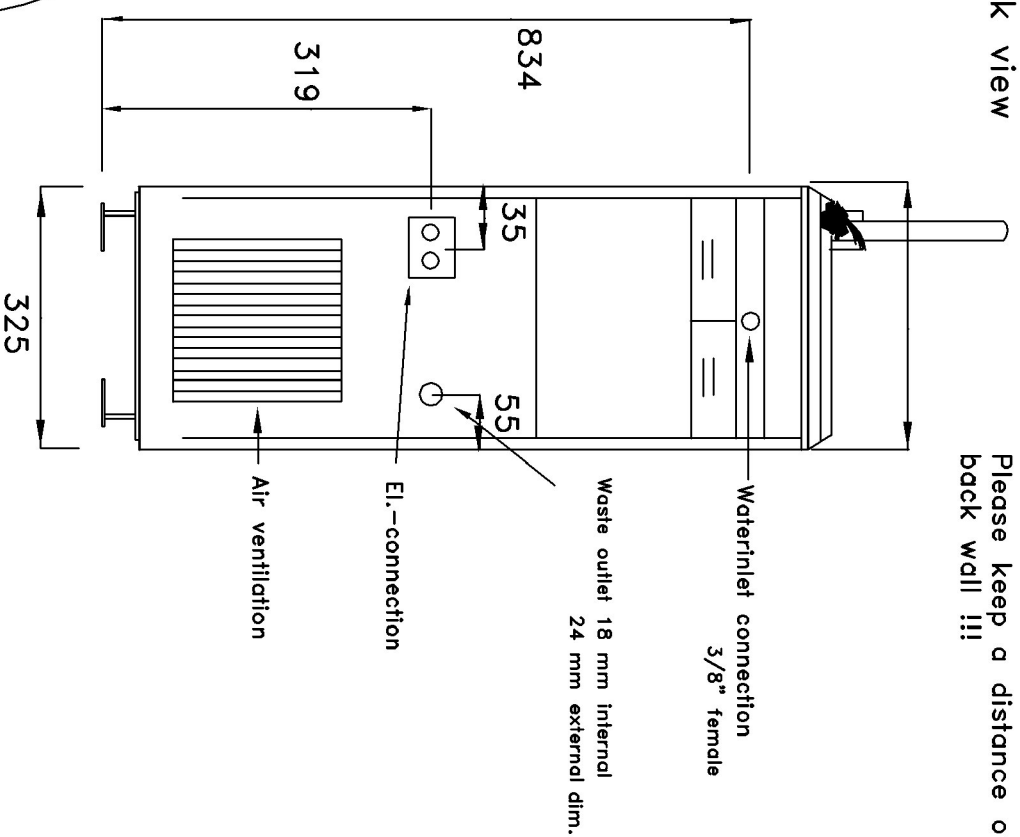

Waste outlet 18 mm internal
24 mm external dim.

—Waterinlet connection
3/8" female

El.-connection

Air ventilation

Technical drawing of a rectangular object, likely a piece of furniture or equipment. The drawing shows a side view with a large rectangular body and a smaller rectangular section on the left. The dimensions are indicated by arrows and numbers: the width of the large body is 984, and the height of the smaller section is 340.

Max. water pressure allowed: 3 bar.

Wir behalten uns vor, die technischen Spezifikationen im Interesse der Weiterentwicklung zu verändern.
We reserve the right to modify the specifications if necessary.

PLOT OUT OF SCALE

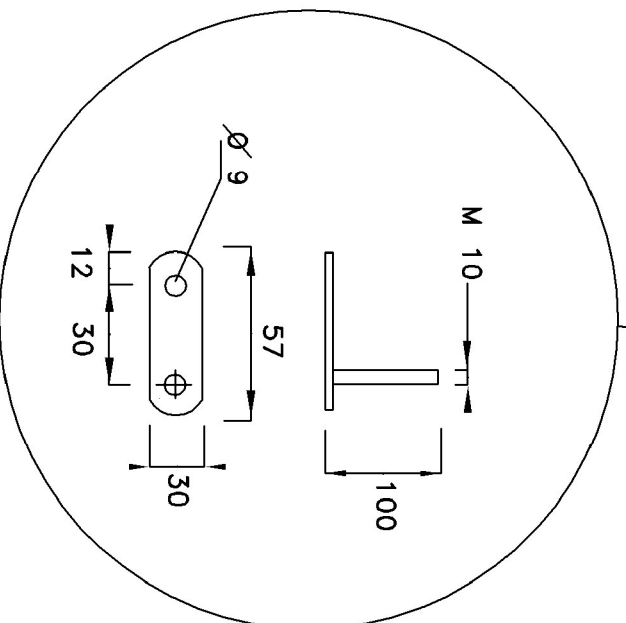

Foot design

ITEM: Drinking water cooler Trinkwasserkühler DWCB25AB / DWCB50AB	THIS DRAWING REMAINS THE PROPERTY OF WESCO Navy	DRAW.	KO	20.12.15
		REV.	-	-

DRAWING NR.

Tel.: +49 40 600 094 680 Fax.: +49 40 536 75 01

E-mail: Info@wesco-navy.de

WIRING DIAGRAM

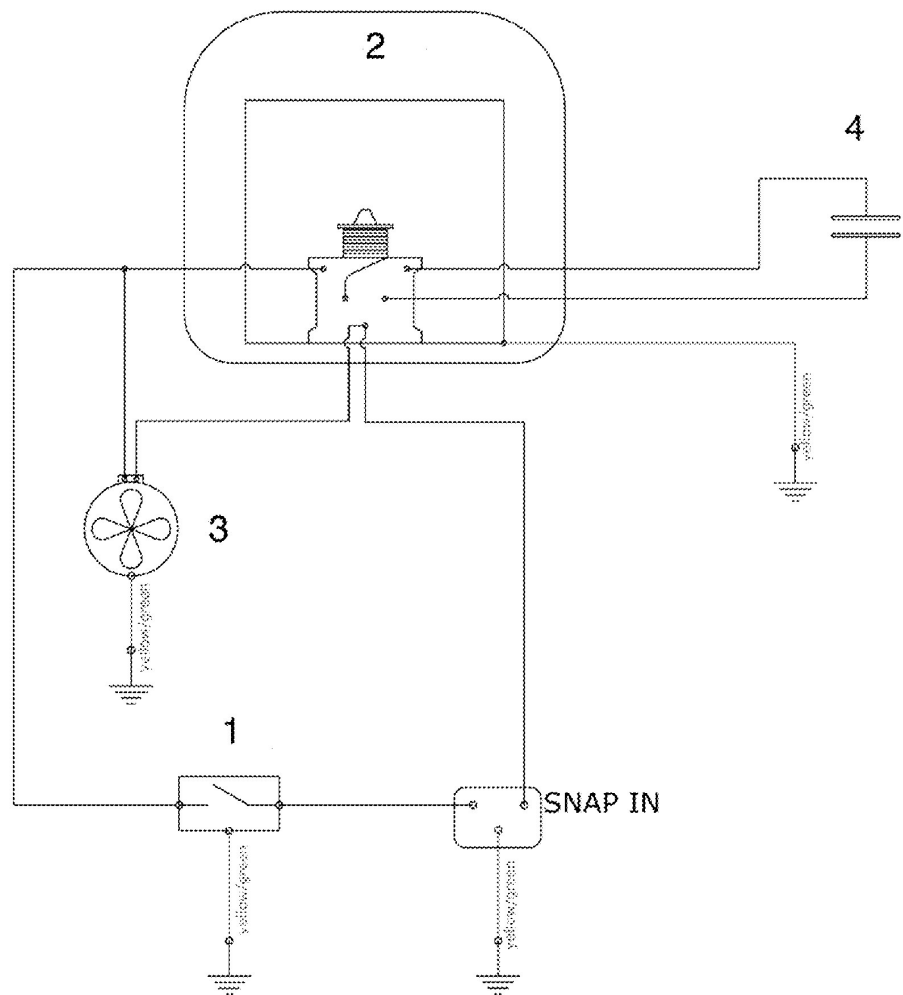

- 1 THERMOSTAT
- 2 COMPRESSOR
- 3 MOTOR FUN
- 4 CAPACITOR

RATED VOLTAGE V 230/1/50 Hz
 V 230/1/60 Hz

TOTAL POWER DWCB25 160 W
 DWCB50 180 W