



*Picture is showing the standard version in a smaller size*

Cold counter with sneeze guard and light  
CCP4/3GN\*

Tel.: +49 40 600 094 680 E-Mail.: [info@wesco-navy.de](mailto:info@wesco-navy.de)

## Cold counter CCP4/3GN\*

Heating.....0,40KW

Light.....0,35KW

-----  
Total capacity.....0,75 KW

=====

### **Marine Execution**

- Coolbasin with space for 4 x GN 1/1.
- Strong and reliable system.
- Easy to clean.
- Gastronorm size for drawers and cupboard.
- Fitted with automatic defrost and melt water evaporation.
- Made of stainless steel.
- 3 doors. The doors have marine handles.  
Room is cooled +2°C-+15°C.
- Adjustable feet.
- With built-up with light and sneeze guards over the basins.
- **With sneeze guard and light!**
- Container are not included.

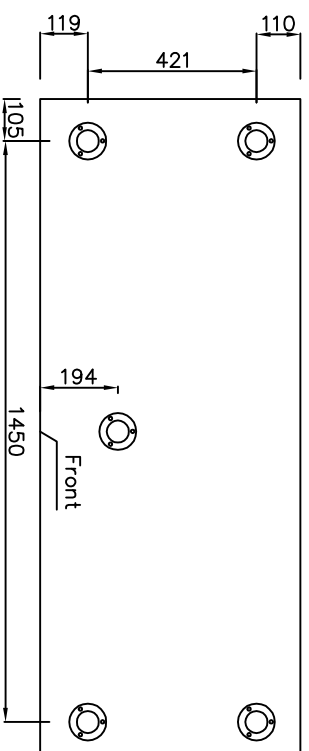
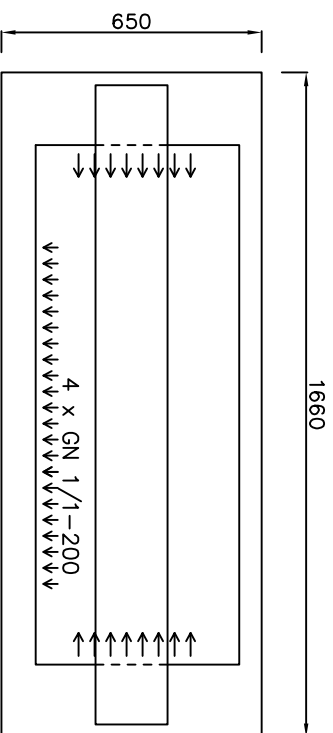
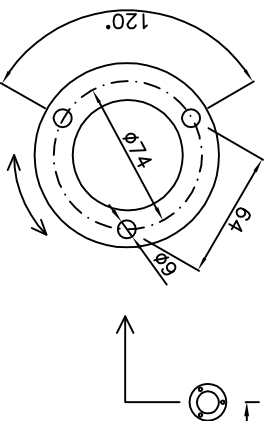
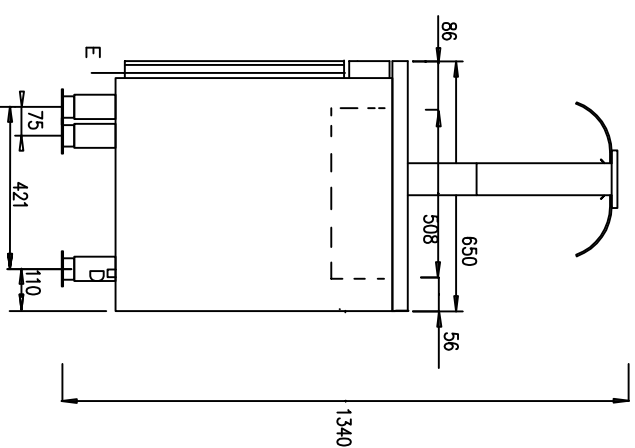
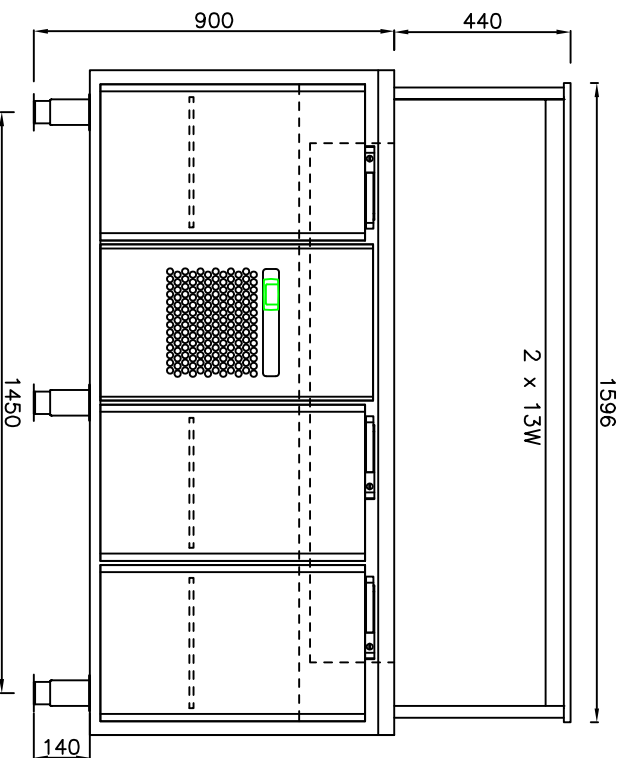

D = drain  
E = el. connection

Wir behalten uns vor, die technischen Spezifikationen im Interesse der Weiterentwicklung zu verändern.  
We reserve the right to modify the specifications if necessary.

PLOT OUT OF SCALE

ITEM:	Cold counter		CCP4-3GN			DRAW.	AW	02.03.19
	Kühlisch			THIS DRAWING REMAINS THE PROPERTY OF WESCO Navy		REV.	-	-
Tel.: +49 40 600 094 880 Fax.: +49 40 536 75 01				WESCO Navy				
E-mail: Info@wesco-navy.de				Hamburg				

