



Refrigerated counter / Kühltesen
CCP3GN

Tel.: +49 40 600 094 680 E-Mail.: info@wesco-navy.de

Cold counter CCP3GN

Total capacity.....0,4 KW
=====

Marine Execution

- Coolbasin with space for 3 x GN 1/1.
- strong and reliable system.
- Easy to clean.
- Gastronorm size for drawers and cupboard.
- Fitted with automatic defrost and melt water evaporation.
- Made of stainless steel.
- 1 door. The door has a lockable handle.
Room is cooled +2°C-+12°C.
- Adjustable feet.

Technical drawing of a circular part. The drawing shows three concentric circles. The outermost circle is labeled with a diameter of $\varnothing 74$. The middle circle is labeled with a diameter of $\varnothing 92$. The innermost circle is labeled with a diameter of $\varnothing 9$. A radial line is drawn from the center to the outer circle, and another radial line is drawn from the center to the middle circle. The angle between these two radial lines is labeled 120° . There are three small circles, each with a cross inside, located on the outer circle. The drawing is a technical drawing of a circular part, likely a flange or a disk, showing concentric circles and a specific angle.

D > Drain, outlet valve 1/2"

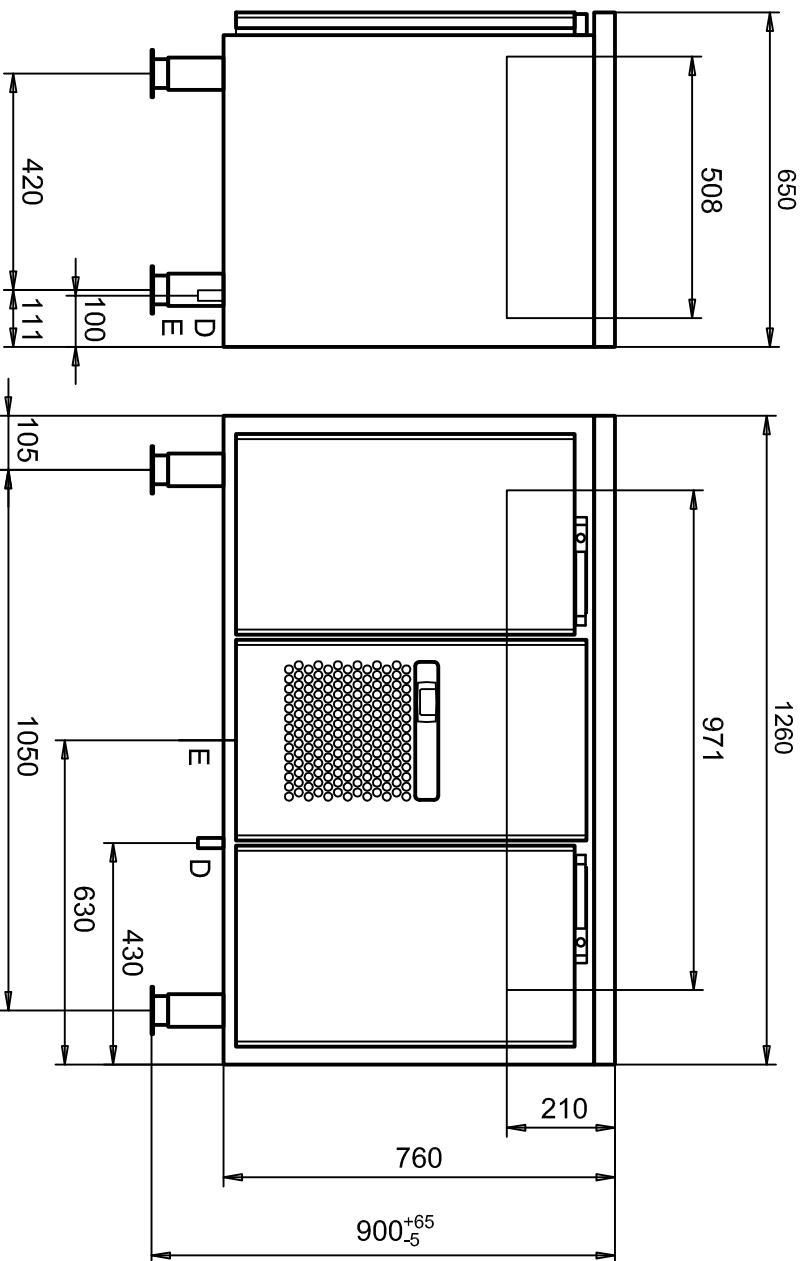

PLOT OUT OF SCALE

Refrigerated counter
Kühlresen

THIS DRAWING REMAINS
THE PROPERTY OF
WESCO Navy

REV.

1

1

la.: +49 40 600 094 680 fax.: +49 40 336 / 3 01

E-mail.: Info@wesco-navy.de

Hamburg