



Food waste disposer
723

Tel.: +49 40 600 094 680 E-Mail.: info@wesco-navy.de

Food waste disposer 723

Motor.....1,1KW

Total capacity.....1,1KW

=====

Marine Execution

Installation : Under-sink-model !

Capacity : 200 Kg/h

Motor : 1,1 kW

Running direct. : 2 ways

Water consume : 6 Liters/min.

Water control : Automatic solenoid valve
operation in conjunction
with motor.

Waste connect. : 54mm pipe.

- Constructed for use on ships.
- Control box included.
- Built in motor protection.
- Smoothly running.
- Sufficient for 50-75 persons.

IMPORTANT:

- The food waste disposer has a motor of 1,1KW. Thus this model has limits for what it can do.

Heavy bones should be cut up before they are put into the machine.

Control that ca. 6 l/m. of water are flowing through the machine by operation.

Top view

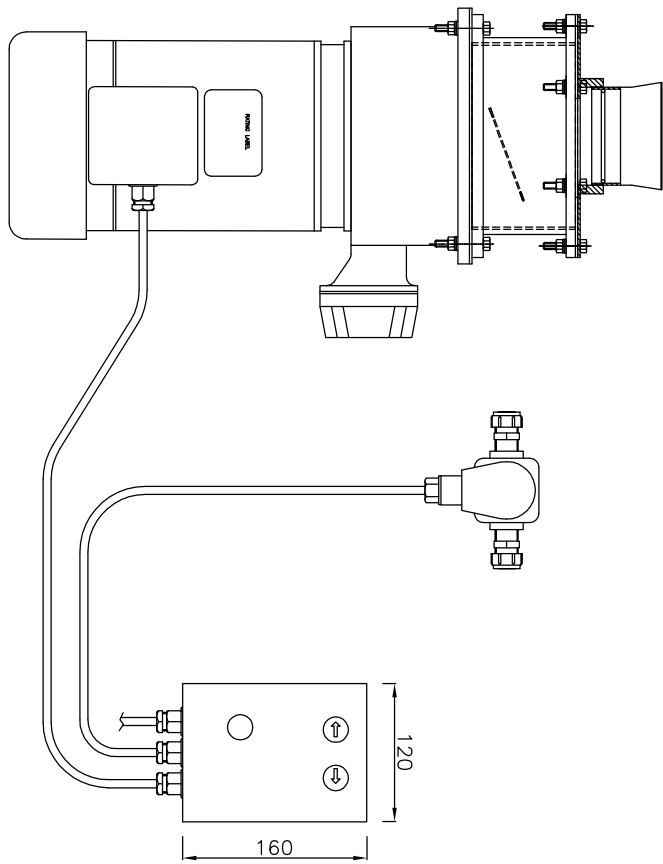
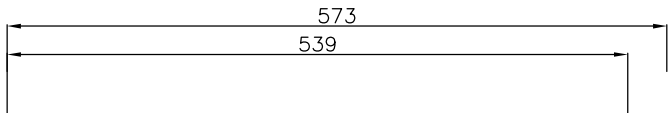
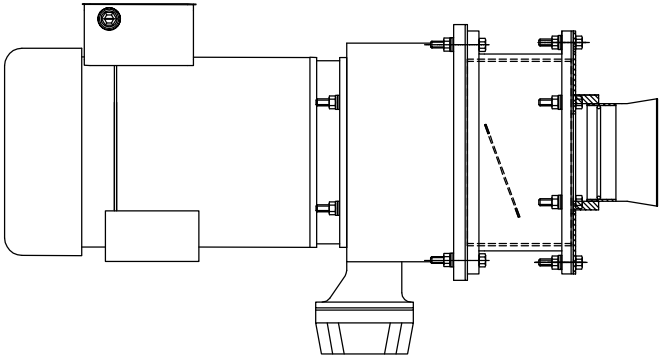
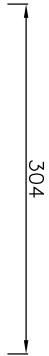
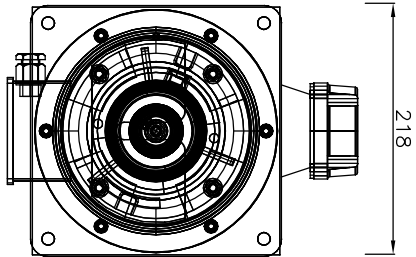

Wir behalten uns vor, die technischen Spezifikationen im Interesse der Weiterentwicklung zu verändern*. = Cable gland We reserve the right to modify the specifications if necessary.

PLOT OUT OF SCALE

ITEM:		DRAW.	
Food waste disposer		KO	
Abfallzerkleinerer		21.02.21	
723		REV.	
THIS DRAWING REMAINS THE PROPERTY OF WESCO Navy		-	

Tel.: +49 40 600 094 680 Fax.: +49 40 536 75 01		DRAWING NR.	
E-mail.: Info@wesco-navy.de			

WIRING DIAGRAMS

Figure 1 - Wiring Diagram, Single Phase

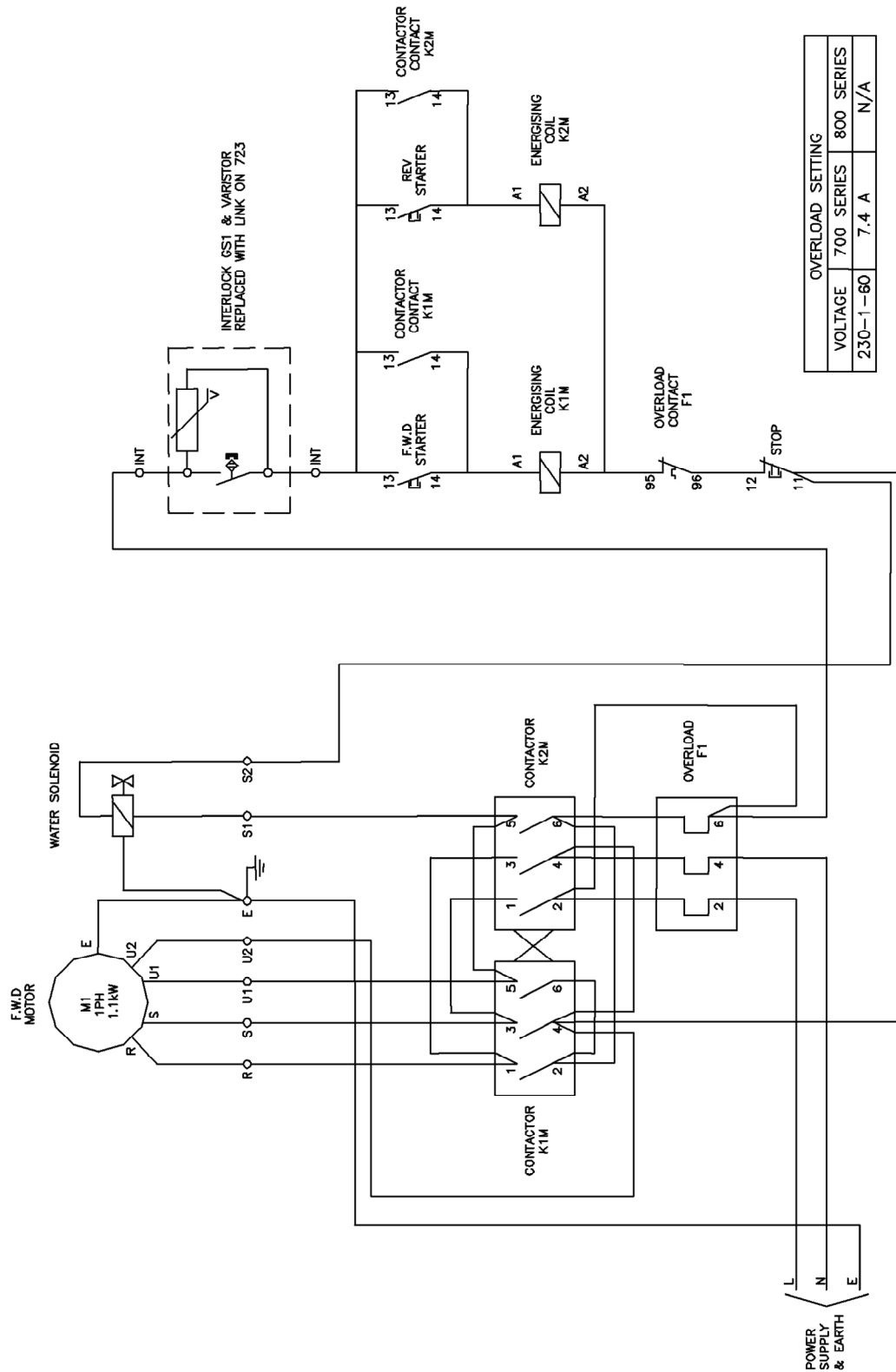

Figure 2 - Wiring Diagram, 3 Phase 4 Wire

